

# EP 304 tabell

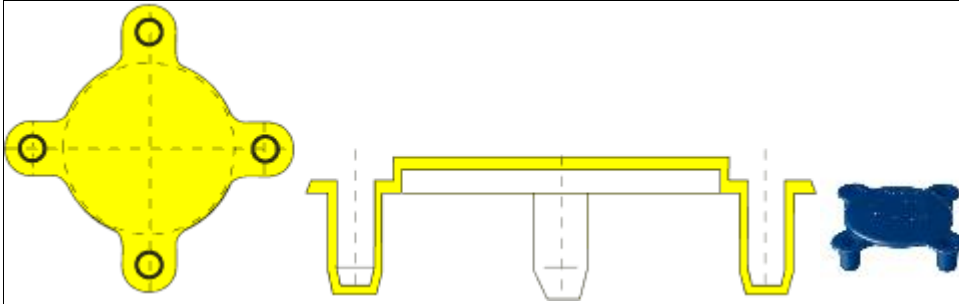

## EP 304

Dimensions Nom Ø	lbs. Series Pressure Group	Standard Pack	Reference No.	Note Product
.1/2"	125, 150 lbs	800	EP 304 / .1/2" / 150	<input type="checkbox"/>
.1/2"	300, 600 lbs	800	EP 304 / .1/2" / 300	<input type="checkbox"/>
.3/4"	125, 150 lbs	800	EP 304 / .3/4" / 150	<input type="checkbox"/>
.3/4"	300, 600 lbs	500	EP 304 / .3/4" / 300	<input checked="" type="checkbox"/>
1."	125, 150 lbs	600	EP 304 / 1." / 150	<input type="checkbox"/>
1."	300, 600 lbs	400	EP 304 / 1." / 300	<input type="checkbox"/>
1.1/2"	125, 150 lbs	400	EP 304 / 1.1/2" / 150	<input type="checkbox"/>
1.1/2"	300, 600 lbs	250	EP 304 / 1.1/2" / 300	<input type="checkbox"/>
2."	125, 150 lbs	250	EP 304 / 2." / 150	<input type="checkbox"/>
2."	300, 600 lbs	200	EP 304 / 2." / 300	<input type="checkbox"/>
3."	125, 150 lbs	200	EP 304 / 3." / 150	<input type="checkbox"/>
3."	300, 600 lbs	175	EP 304 / 3." / 300	<input type="checkbox"/>
4."	125, 150 lbs	200	EP 304 / 4." / 150	<input type="checkbox"/>
4."	300 lbs	175	EP 304 / 4." / 300	<input type="checkbox"/>
6."	125, 150 lbs	125	EP 304 / 6." / 150	<input type="checkbox"/>
6."	300 lbs	125	EP 304 / 6." / 300	<input type="checkbox"/>
8."	150 lbs	100	EP 304 / 8." / 150	<input type="checkbox"/>
8."	300 lbs	100	EP 304 / 8." / 300	<input type="checkbox"/>
10."	150 lbs	60	EP 304 / 10." / 150	<input type="checkbox"/>
10."	300 lbs	60	EP 304 / 10." / 300	<input type="checkbox"/>
12."	150 lbs	40	EP 304 / 12." / 150	<input type="checkbox"/>
12."	300 lbs	30	EP 304 / 12." / 300	<input type="checkbox"/>
Dimensions Nom Ø	lbs. Series Pressure Group	Standard Pack	Reference No.	Note Product



# EP 310 tabell

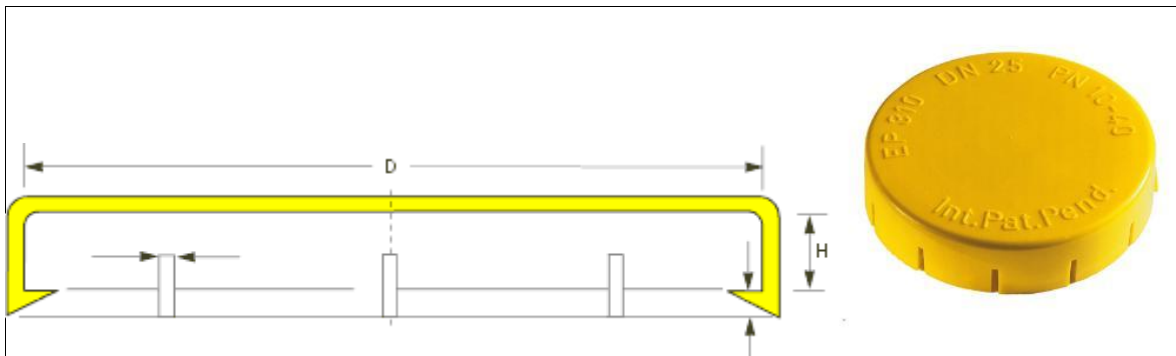

All dimensions in mm

## ANSI B 16.5

Dimensions Nom Ø	Series Pressure Group	D Ø Flange	H Int. Protector Depth		Standard Pack	Reference No.
.1/2"	150	89.0	14.2	4.5	250	EP 310/ .1/2" /150
.1/2"	300	95.0	17.0	4.5	250	EP 310/ .1/2" /300
.1/2"	600	95.0	17.0	4.5	250	EP 310/ .1/2" /600
.3/4"	150	98.5	15.7	4.5	200	EP 310/ .3/4" /150
1."	150	108.0	17.5	4.5	150	EP 310/ 1." /150
1."	300	124.0	20.5	4.5	150	EP 310/ 1." /300
1."	600	124.0	20.5	4.5	150	EP 310/ 1." /600
1.1/2"	150	127.0	20.5	4.5	175	EP 310/ 1.1/2" /150
2."	150	152.4	22.1	4.5	100	EP 310/ 2." /150
2."	300	165.0	21.0	4.5	100	EP 310/ 2." /300
3."	150	190.5	27.0	4.5	60	EP 310/ 3." /150
4."	150	228.5	28.0	7.0	40	EP 310/ 4." /150
6."	150	279.5	29.0	7.0	25	EP 310/ 6." /150
10."	150	406.5	30.0	12.0	20	EP 310/10." /150